

NATIONAL ORGANIZATION
SONS OF UNION VETERANS OF THE CIVIL WAR
CIVIL WAR MEMORIAL ASSESSMENT FORM

PLEASE:

- Type or print, using a ball-point pen, when filling out this form. Legibility is critical.
- Do not guess at the information. An answer of, "Unknown," is more helpful.
- Include a photograph of each viewable side and label it with name & direction of view.

- Thank You.

Type of Memorial

Monument *with* Sculpture ___ Monument with Cannon
 ___ Monument without Sculpture ___ Historical Marker ___ Plaque

Affiliation

___ G.A.R. (Post Name & No. _____) ___ M.O.L.L.U.S.
 ___ W.R.C. (Corps Name & No. _____) ___ Other Allied Order
 ___ SUVCW (Camp Name & No. _____) (Please describe below)
 ___ DUVCW (Tent Name & No. _____)
 Other: 1st Battalion 13th US Infantry _____

Original Dedication Date 1864 _____ Please consult any/all newspaper archives for a local paper's article that would have information on the *first* dedication ceremony and/or other facts on the memorial. Please submit a copy of your findings with full identification of the paper & date of publication. Thank you.

Location

The Memorial is *currently* located at:

Street/Road address or site location Block 17 Lot 8, Calvary Cemetery, 5329 W. Florissant
 City/Village St. Louis Township _____ County St Louis City

The front of the Memorial faces: ___ North ___ South East ___ West

Government Body, Agency, or Individual Owner (of private cemetery that Memorial is located in)...

Name Calvary Cemetery Dept./Div. _____

Street Address 5329 West Florissant Rd

City St. Louis State MO Zip Code 63115

Contact Person _____ Telephone (314) 381-1313

If the Memorial has been moved, please list former location(s)...

N/A

Physical Details

Material of Monument or base under a Sculpture or Cannon = Stone ___ Concrete ___ Metal ___ Undetermined
 If known, name specific material (color of granite, marble, etc.) Marble

Material of the Sculpture = Stone Concrete Metal Undetermined
If known, name specific material (color of granite, marble, etc.) Grey Colored Marble
If the Sculpture is of metal, is it solid cast or "hollow?" N/A

Material of Plaque or Historical Marker / Tablet = n/a

Material of Cannon = Bronze Iron - Consult known Ordnance Listing to confirm
Markings on muzzle = n/a

Markings on Left Trunion _____ Right Trunion _____

Is inert ammunition a part of the Memorial? If so, describe _____

Approximate Dimensions (indicate unit of measure) - taken from tallest / widest points
Monument or Base: Height _____ Width _____ Depth _____ or Diameter _____
Sculpture: Height 6 ft 6 in Width 3 feet Depth 3 feet or Diameter _____

For Memorials with multiple Sculptures, please record this information on a separate sheet of paper for each statue and attach to this form. Please describe the "pose" of each statue and any weapons/implements involved (in case your photos become separated from this form). Thank you!

Markings/Inscriptions (on stone-work / metal-work of monument, base, sculpture)

Maker or Fabricator mark / name? If so, give name & location found None

The "Dedication Text" is formed: cut into material raised up from material face

Record the text (indicate any separation if on different sides...) Please use additional sheet if necessary.
William T.

Son of William T. and Ellen E. Sherman
Born in San Francisco, Cal. June 8, 1854
Died in Memphis, Tenn. October 3, 1863
In His Spirit There Was No Guile
Our Little Sergeant
Willie
From 1st Battalion 13th US Infantry

Environmental Setting

(The general vicinity and immediate locale surrounding a memorial can play a major role in its overall condition.)

Type of Location

- | | | |
|--|---|--|
| <input checked="" type="checkbox"/> Cemetery | <input type="checkbox"/> Park | <input type="checkbox"/> Plaza/Courtyard |
| <input type="checkbox"/> "Town Square" | <input type="checkbox"/> Post Office | <input checked="" type="checkbox"/> School |
| <input type="checkbox"/> Municipal Building | <input type="checkbox"/> State Capitol | Other: _____ |
| <input type="checkbox"/> Courthouse | <input type="checkbox"/> College Campus | _____ |
| <input type="checkbox"/> Traffic Circle | <input type="checkbox"/> Library | _____ |

Surface Coating

Does there appear to be a coating? Yes No Unable to determine

If known, identify type of coating.

Gilded Painted Varnished Waxed Unable to determine

Is the coating in good condition? Yes No Unable to determine

Basic Surface Condition Assessment (check one)

In your opinion, what is the general appearance or condition of the Memorial?

Well maintained Would benefit from treatment In urgent need of treatment Unable to determine

Overall Description

Briefly describe the Memorial (affiliation / overall condition & any concern not already touched on) .

Supplemental Background Information

In addition to your on-site survey, any additional information you can provide on the described Memorial will be welcomed. Please label each account with its source (author, title, publisher, date, pages). Topics include any reference to the points listed on this questionnaire, plus any previous conservation treatments - or efforts to raise money for treatment. Thank you.

Inspector Identification

Date of On-site Survey 25 July 2006

Your Name Walter E. Busch, US Grant Camp #68

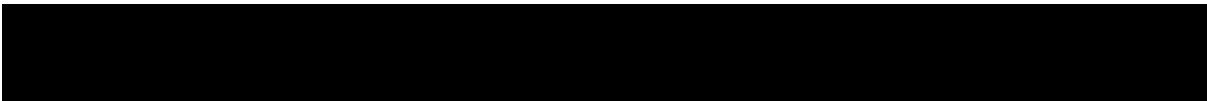

Please send this completed form to:

Todd A. Shillington, PDC

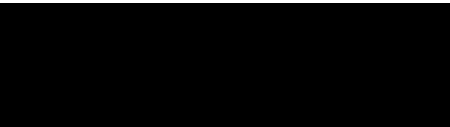

Thank you for your help, and attention to detail.

SONS OF UNION VETERANS OF THE CIVIL WAR
National Civil War Memorials Committee

Wille T. Sherman's Monument

CALVARY AVENUE

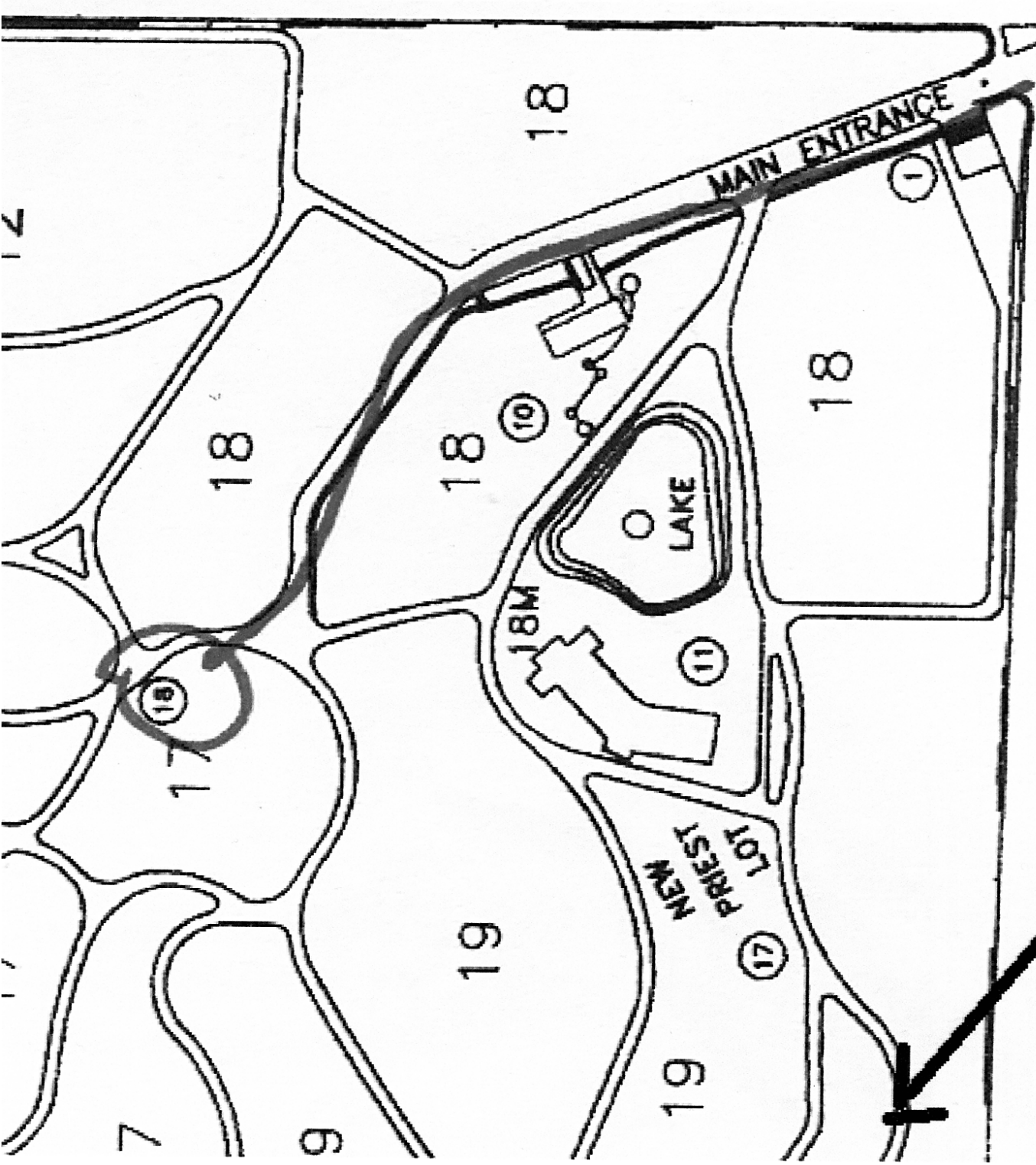

5329 West Florissant Rd 63146

ARLING

EMERS

1000



LE EWING
AN
STER OHIO
1824
DIAK CITY
3 1888
have I loved

WILLIAM T.
SHERMAN
BORN IN SAN FRANCISCO CAL.
DIED IN MEMPHIS TENN.
OCTOBER 7 1882

OUR LITTLE SERGEANT
WILLIE
TOWN 1ST BATTALION 13TH U. S. INFANTRY

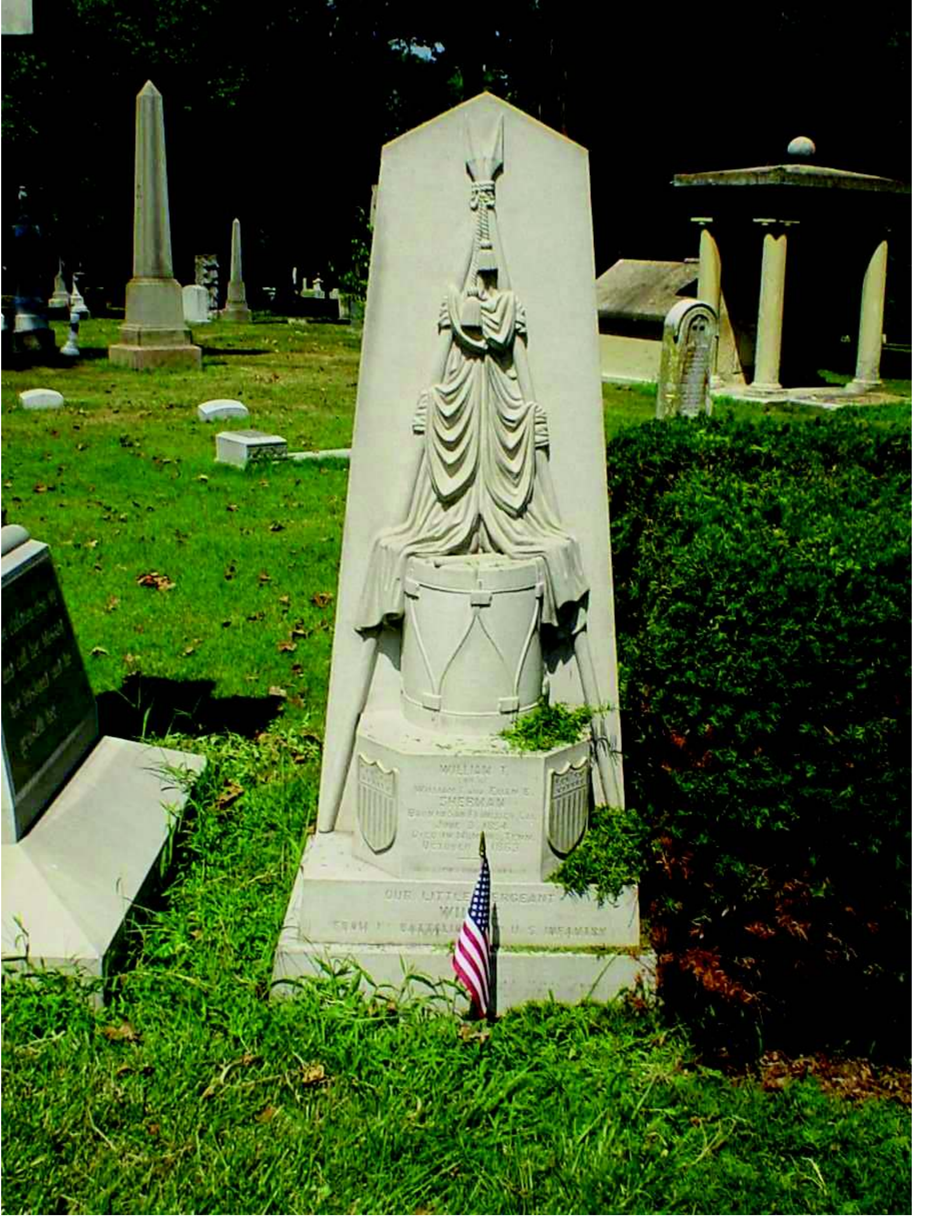

WILLIAM T.
JERMAN
BORN [illegible]
DIED [illegible]
[illegible]

OUR LITTLE SERGEANT
WILLIAM T. JERMAN
1864 - 1900 U. S. INFANTRY