

NATIONAL ORGANIZATION
SONS OF UNION VETERANS OF THE CIVIL WAR
 CIVIL WAR MEMORIAL ASSESSMENT FORM

PLEASE:

- Type or print, using a ball-point pen, when filling out this form. Legibility is critical.
- Do not guess at the information. An answer of, "Unknown," is more helpful.
- Include a photograph of each viewable side and label it with name & direction of view.

- Thank You.

Type of Memorial

Monument *with* Sculpture Monument with *Cannon*
 Monument *without* Sculpture Historical Marker Plaque

Affiliation

G.A.R. (Post Name & No. _____) M.O.L.L.U.S.
 W.R.C. (Corps Name & No. _____) Other Allied Order
 SUVCW (Camp Name & No. _____) (Please describe below)
 DUVCW (Tent Name & No. _____)
 Other: Missouri Department of Natural Resources Civil War Marker Program

Original Dedication Date 29 April 2008 Please consult any/all newspaper archives for a local paper's article that would have information on the *first* dedication ceremony and/or other facts on the memorial. Please submit a copy of your findings with full identification of the paper & date of publication. Thank you.

Location

The Memorial is *currently* located at:

Street/Road address or site location County Road 228, Chalk Bluff Trail Access W90° 09'22" N36° 29'03"
 City/Village Campbell Township _____ County Dunklin

The front of the Memorial faces: North South East West

Government Body, Agency, or Individual Owner (of private cemetery that Memorial is located in)...

Name Missouri Dept of Conservation Dept./Div. _____
 Street Address PO Box 180
 City Jefferson City State MO Zip Code 65102
 Contact Person _____ Telephone (573) 751-4115

If the Memorial has been moved, please list former location(s)...

N/A

Physical Details

Material of Monument or base under a Sculpture or Cannon = Stone Concrete Metal Undetermined
 If known, name specific material (color of granite, marble, etc.) _____

Material of the Sculpture = Stone Concrete Metal Undetermined
If known, name specific material (color of granite, marble, etc.) _____
If the Sculpture is of metal, is it solid cast or "hollow?" _____

Material of Plaque or Historical Marker / Tablet = Plastic Compound

Material of Cannon = Bronze Iron - Consult known Ordnance Listing to confirm
Markings on muzzle = _____
Markings on Left Trunion _____ Right Trunion _____
Is inert ammunition a part of the Memorial? If so, describe _____

Approximate Dimensions (indicate unit of measure) - taken from tallest / widest points
Monument or Base: Height ^{3 1/2 ft} _____ Width ^{4 in} _____ Depth ^{2 1/2 ft} _____ or Diameter _____
Sculpture: Height _____ Width _____ Depth _____ or Diameter _____

For Memorials with multiple Sculptures, please record this information on a separate sheet of paper for each statue and attach to this form. Please describe the "pose" of each statue and any weapons/implements involved (in case your photos become separated from this form). Thank you!

Markings/Inscriptions (on stone-work / metal-work of monument, base, sculpture)
Maker or Fabricator mark / name? If so, give name & location found n/a

The "Dedication Text" is formed: cut into material raised up from material face

Record the text (indicate any separation if on different sides...) Please use additional sheet if necessary.
see attached due to length

Environmental Setting

(The general vicinity and immediate locale surrounding a memorial can play a major role in its overall condition.)

Type of Location

- | | | |
|---|---|--|
| <input type="checkbox"/> Cemetery | <input type="checkbox"/> Park | <input type="checkbox"/> Plaza/Courtyard |
| <input type="checkbox"/> "Town Square" | <input type="checkbox"/> Post Office | <input checked="" type="checkbox"/> School |
| <input type="checkbox"/> Municipal Building | <input type="checkbox"/> State Capitol | Other: _____ |
| <input type="checkbox"/> Courthouse | <input type="checkbox"/> College Campus | <u>School Marked in error</u> |
| <input type="checkbox"/> Traffic Circle | <input type="checkbox"/> Library | _____ |

General Vicinity

Rural (low population, open land) Suburban (residential, near city)
 Town Urban / Metropolitan

Immediate Locale (check as many as may apply)

Industrial Commercial
 Street/Roadside within 20 feet Tree Covered (overhanging branches)
 Protected from the elements (canopy or enclosure, indoors)
 Protected from the public (fence or other barrier)
 Any other significant environmental factor _____

Condition Information

Structural Condition (check as many as may apply)

The following section applies to Monuments *with* Sculpture, and Monuments without _____ Sculpture - including the base for Monuments with *Cannon*. Instability in the sculpture and its base can be detected by a number of factors. Indicators may be obvious or subtle. Visually examine the sculpture and its base.

Sculpture	_____	Base
If hollow, is the internal support unstable/exposed? (look for signs of exterior rust)	_____	_____
Any evidence of structural instability? (look for cracked joints, missing mortar or caulking or plant growth)	_____	_____
Any broken or missing parts? (look for elements (i.e., sword, musket, hands, arms, etc. - missing due to vandalism, fluctuating weather conditions, etc.)	_____	_____
Any cracks, splits, breaks or holes? (also look for signs of uneven stress & weakness in the material)	_____	_____

Surface Appearance (check as many as may apply)

	Sculpture	Base
Black crusting	<input type="checkbox"/>	<input type="checkbox"/>
White crusting	<input type="checkbox"/>	<input type="checkbox"/>
Etched, pitted, or otherwise corroded (on metal)	<input type="checkbox"/>	<input type="checkbox"/>
Metallic staining (run-off from copper, iron, etc.)	<input type="checkbox"/>	<input type="checkbox"/>
Organic growth (moss, algae, lichen or vines)	<input type="checkbox"/>	<input type="checkbox"/>
Chalky or powdery stone	<input type="checkbox"/>	<input type="checkbox"/>
Granular eroding of stone	<input type="checkbox"/>	<input type="checkbox"/>
Spalling of stone (surface splitting off)	<input type="checkbox"/>	<input type="checkbox"/>
Droppings (bird, animal, insect remains)	<input type="checkbox"/>	<input type="checkbox"/>
Other (e.g., spray paint graffiti) - Please describe... good shape	_____	_____

Does water collect in recessed areas of the Memorial? Yes No Unable to tell

Surface Coating

Does there appear to be a coating? Yes No Unable to determine
If known, identify type of coating.

Gilded Painted Varnished Waxed Unable to determine

Is the coating in good condition? Yes No Unable to determine

Basic Surface Condition Assessment (check one)

In your opinion, what is the general appearance or condition of the Memorial?

Well maintained Would benefit from treatment In urgent need of treatment Unable to determine

Overall Description

Briefly describe the Memorial (affiliation / overall condition & any concern not already touched on) .

Printed wording on this type of monument starts showing age after about 5 years. Recommend reinspection in 2014

Supplemental Background Information

In addition to your on-site survey, any additional information you can provide on the described Memorial will be welcomed. Please label each account with its source (author, title, publisher, date, pages). Topics include any reference to the points listed on this questionnaire, plus any previous conservation treatments - or efforts to raise money for treatment. Thank you.

Inspector Identification

Date of On-site Survey 11/14/2008

Your Name Walter E Busch, US Grant Camp 68

Please send this completed form to:

Kevin P. Tucker, PDC, Chair

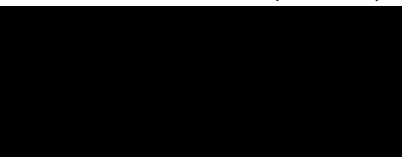

Thank you for your help, and attention to detail.

SONS OF UNION VETERANS OF THE CIVIL WAR
National Civil War Memorials Committee

CHALK BLUFF TRAIL ACCESS

DUNKLIN COUNTY
83 ACRES

Take Hwy 62 south from Campbell,
then right 3 miles on Co. Rd 232,
and left 1.25 miles on Co. Rd 228
to St. Francis River.

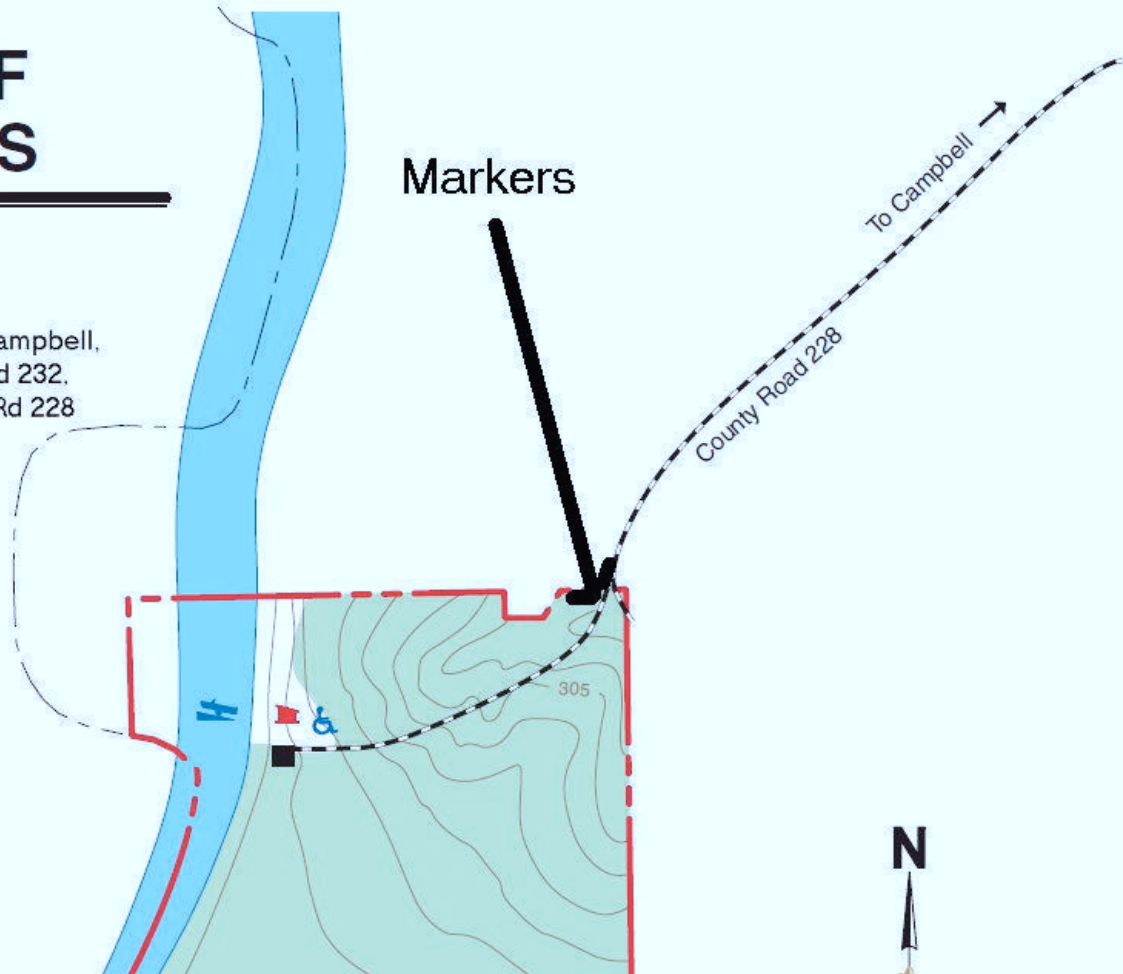



Gen. John McNeil

THE BATTLE AT CHALK BLUFF

A STATE DIVIDED:
THE CIVIL WAR IN MISSOURI
MISSOURI DEPARTMENT OF NATURAL RESOURCES



Brig. Gen. John S. Marmaduke



The Battle at Chalk Bluff

Down the hill from this marker is the place where four brigades of Confederates, led by Brig. Gen. John Sappington Marmaduke, crossed the St. Francis River into the safety of Arkansas on May 3-4, 1864. The clash with Union troops at Chalk Bluff was the last fight of Marmaduke's second expedition into Missouri, usually known as the Cape Girardeau Raid, in April 17-May 3, 1864. The fleeing Confederates were hotly pursued by Union troops, led by Gen. John McNeil, and their narrow escape into Arkansas was only successful due to the hasty construction of a makeshift bridge at the crossing.

Marmaduke was a week into his southeastern Missouri raid when he decided to attack the important Federal supply depot at Cape Girardeau. He found the town too well defended by the Federal force under McNeil and withdrew to Jackson. Pursued by Union troops, the Confederates left Jackson for Bloomfield on April 27.

Nearly constant skirmishing occurred all the way to Bloomfield and their retreat was hindered by persistent rain, muddy roads and high water. After sharp fights at the bridges on the Whitewater and Gator rivers, the Confederates destroyed both of the bridges during their retreat, this forced the Union troops to rebuild them in order to continue their pursuit. Marmaduke intended to fight at Bloomfield, but because his troops were outnumbered, he retreated south toward Chalk Bluff, where he intended to cross the St. Francis River into Arkansas.

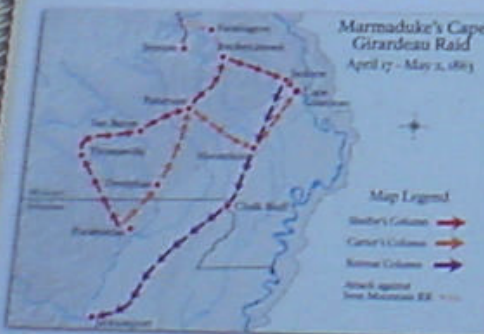

The Cape Girardeau Raid

Brig. Gen. John S. Marmaduke's second expedition into Missouri in 1864 is usually known as the Cape Girardeau Raid. Marmaduke undertook the raid to show a Confederate presence in Missouri, recruit men, and gather provisions for his ill-supplied brigades. As with Marmaduke's first expedition in January 1864, Confederate authorities hoped that a Missouri incursion would relieve Federal pressure on Little Rock and Vicksburg. At the time of the second raid, Union forces had major bases at Cape

Union Troops Occupy Bloomfield

The pursuing Union troops occupied Bloomfield easily as the Confederates had already begun their retreat by the time the Union forces arrived. Brig. Gen. William Vandever, who had brought reinforcements from Pilot Knob during the Confederate assault on Cape Girardeau, assumed command of the operation. He placed McNeil in charge of two fresh brigades to continue the advance against the retreating Confederates. McNeil got his troops under way slowly and was hindered by bad roads that ran through swamps and thick forest. This permitted the rebels to check the Union advance easily. On May 4, McNeil's force skirmished with the Confederate rear guard until they passed through Four Mile, a village located four miles from the St. Francis River.



Brig. Gen. William Vandever

The Confederates established a strong defensive position about a mile farther toward Chalk Bluff at Gravel Hill. With Marmaduke's men concealed behind crude breastworks constructed of logs and brush, the 3rd Missouri Cavalry Regiment (Union), charged into the ambush and received severe fire from the Confederates. Unable to withstand the punishment, the regiment fell back until the Union artillery and reinforcements could be brought forward. Although full of fight by this time, McNeil's men accomplished little before darkness fell.

Girardeau and Pilot Knob, occupied the primary towns in the region such as Fredericktown and Bloomfield and manned outposts along the major roads leading toward Arkansas at such towns as Patterson.

On April 18, 1864, Marmaduke entered southeast Missouri in two columns. He led about 5,000 men including nearly 2,000 unarmed and soon shot due to a shortage of weapons and mounts. Colonels John Q. Burbridge, Colton Greene, and Joseph G. Shelby commanded three brigades of Missourians and Arkansians; Col. George W. Carter commanded a brigade of Texas troopers. Missouri and Texas artillery batteries totaling eight guns accompanied the expedition.

After stampeding the small garrison at Patterson on April 20, Marmaduke targeted Gen. John McNeil, a man despised by Confederates for rescuing prisoners in northeast Missouri in 1862. McNeil commanded the garrison at Bloomfield. Marmaduke dispatched Carter's Texas Brigade to drive McNeil from Bloomfield to Fredericktown where Marmaduke planned to entrap the Yankee and his command. McNeil escaped Bloomfield before Carter arrived, but, instead of marching toward Fredericktown, rode rapidly to Cape Girardeau with the Texans in pursuit. Marmaduke moved to Cape Girardeau to assist Carter, but Union forces repulsed his attack there on April 26. The Confederates disengaged and camped that night at Jackson. Assaulted the next morning by Gen. William Vandever's Union reinforcements from Pilot Knob, Marmaduke's brigades began a fighting retreat to Arkansas.

Confederates Build a Bridge at Chalk Bluff

Before leaving Bloomfield on April 30, Marmaduke sent a detail of unarmed men forward to construct a bridge over the flooded St. Francis River at Chalk Bluff. The detail, commanded by Maj. Robert Smith, built a rickety bridge of logs tied together with rope and vines anchored on each bank. They also built a log raft to convey the artillery across the treacherous river. While hardly an engineering marvel, the bridge proved serviceable. Gen. M. Jeff Thompson, the "Swamp Fox," assisted in building the rickety bridge.

During the night on May 4, the Confederates began withdrawing across the St. Francis River, one brigade at a time, to the high ground at Chalk Bluff on the Arkansas side. The fragile bridge supported only a single file of troops. Horses had to swim the swirling river and several drowned in the process. Thompson, in charge of crossing the artillery, disassembled the guns and sent the parts over the river on the raft. By daylight on May 4, Marmaduke's entire command, except pickets and a few stragglers, had crossed the river, with the Federals totally unaware of the movement. The Confederates cast off the bridge and raft and let them drift away downstream.



Gen. M. Jeff Thompson

Later that morning, McNeil's brigades moved toward the river, hoping to destroy the Confederate command. The rebels on the Arkansas shore greeted them with heavy fire that unhorsed McNeil and his aide and killed and wounded several of his men. The Union artillery opened a heavy but ineffective cannonade. The Confederates marched away without loss, thus concluding the fight at Chalk Bluff.

Aftermath of the Battle of Chalk Bluff

Casualties from the encounter at Chalk Bluff cannot be determined with certainty, but they were doubtless low. Vandever estimated Union losses at no more than 50 killed, wounded and missing. The Confederates probably suffered similar losses.

Marmaduke scored a tactical victory at Chalk Bluff by avoiding a major engagement with his back against the river, thereby saving his army. But strategically his raid had been a failure. He could not maintain a presence in Missouri and gained only enough recruits to replace his losses. His men remained poorly armed and fed. The raid did not divert the Federals from moving into northern Arkansas. Gen. U. S. Grant initiated his final campaign for Vicksburg on May 1 by defeating the Confederates at Port Gibson, Miss. This was the same day that Marmaduke fought a delaying action to avoid disaster on the St. Francis River.

The Battle at Chalk Bluff

[US Shield]

[Picture of Gen. John McNeil]

A State Divided:

The Civil War in Missouri

Missouri Department of Natural Resources

[DNR Logo]

[Picture: Brig. Gen. John S. Marmaduke]

[Confederate Shield]

The Battle at Chalk Bluff

Down the hill from this marker is the place where four brigades of Confederates, led by Brig. Gen. John Sappington Marmaduke, crossed the St. Francis River into the safety of Arkansas on May 1-2, 1863. The clash with Union troops at Chalk Bluff was the last fight of Marmaduke's second expedition into Missouri, usually known as the Cape Girardeau Raid, in April 17-May 2, 1863. The fleeing Confederates were hotly pursued by Union troops, led by Gen. John McNeil, and their narrow escape into Arkansas was only successful due to the hasty construction of a makeshift bridge at the crossing.

Marmaduke was a week into his southeastern Missouri raid when he decided to attack the important Federal supply depot at Cape Girardeau. He found the town too well defended by the Federal force under McNeil and withdrew to Jackson. Pursued by Union troops, the Confederates left Jackson for Bloomfield on April 27.

Nearly constant skirmishing occurred all the way to Bloomfield and their retreat was hindered by persistent rain, muddy roads and high water. After sharp fights at the bridges on the Whitewater and Castor rivers, the Confederates destroyed both of the bridges during their [sic] retreat. this [sic] forced the Union troops to rebuild them in order to continue their pursuit. Marmaduke intended to fight at Bloomfield, but because his troops were outnumbered, he retreated south toward Chalk Bluff, where he intended to cross the St. Francis River into Arkansas.

[Map: Marmaduke's Cape Girardeau Raid – April 17 – May 2, 1863]

[Text for Inserted Map: The Cape Girardeau Raid]

Brig. Gen. John S. Marmaduke's second expedition into Missouri in 1863 is usually known as the Cape Girardeau Raid. Marmaduke undertook the raid to show a Confederate presence in Missouri, recruit men, and gather provisions for his ill-supplied brigades. As with Marmaduke's first expedition in January 1863, Confederate authorities hoped that a Missouri incursion would relieve Federal pressure on Little Rock and

Vicksburg. At the time of the second raid, Union forces had major bases at Cape Girardeau and Pilot Knob, occupied the primary towns in the region such as Fredericktown and Bloomfield and manned outposts along the major roads leading toward Arkansas at such towns as Patterson.

On April 18, 1863, Marmaduke entered southeast Missouri in two columns. He led about 5,000 men including nearly 1,200 unarmed and 900 afoot due to a shortage of weapons and mounts. Colonels John Q. Burbridge, Colton Greene, and Joseph O. Shelby commanded three brigades of Missourians and Arkansans; Col. George W. Carter commanded a brigade of Texas troopers. Missouri and Texas artillery batteries totaling eight guns accompanied the expedition.

After stampeding the small garrison at Patterson on April 20, Marmaduke targeted Gen. John McNeil, a man despised by Confederates for executing prisoners in northeast Missouri in 1862. McNeil commanded the garrison at Bloomfield. Marmaduke dispatched Carter's Texas Brigade to drive McNeil from Bloomfield to Fredericktown where Marmaduke planned to entrap the Yankee and his command. McNeil escaped Bloomfield before Carter arrived, but, instead of marching toward Fredericktown, rode rapidly to Cape Girardeau with the Texans in pursuit. Marmaduke moved to Cape Girardeau to assist Carter, but Union forces repulsed his attack there on April 26. The Confederates disengaged and camped that night at Jackson. Assaulted the next morning by Gen. William Vandever's Union reinforcements from Pilot Knob, Marmaduke's brigades began a fighting retreat to Arkansas.

[END INSERTED TEXT]

Union Troops Occupy Bloomfield

The pursuing Union troops occupied Bloomfield easily as the Confederates had already begun their retreat by the time the Union forces arrived. Brig. Gen. William Vandever, who had brought reinforcements from Pilot Knob during the Confederate assault [sic] on Cape Girardeau, assumed command of the operation. He placed McNeil in charge of two fresh brigades to continue the advance against the retreating Confederates. McNeil got his troops under way slowly and was hindered by bad roads that ran through swamps and thick forests. This permitted the rebels to check the Union advance easily. On May 1, McNeil's force skirmished with the Confederate rear guard until they passed through Four Mile, a village located four miles from the St. Francis River.

The Confederates established a strong defensive position about a mile farther toward Chalk Bluff at Gravel Hill. With Marmaduke's men concealed behind crude breastworks constructed of logs and brush, the 3rd Missouri Cavalry Regiment (Union), charged into the ambush and received severe fire from the Confederates. Unable to withstand the punishment, the regiment fell back until the Union artillery and reinforcements could be brought forward. Although full of fight by this time, McNeil's men accomplished little before darkness fell.

[Picture: Brig. Gen. William Vandever]

Confederates Build a Bridge at Chalk Bluff

Before leaving Bloomfield on April 30, Marmaduke sent a detail of unarmed men forward to construct a bridge over the flooded St. Francis River at Chalk Bluff. The detail, commanded by Maj. Robert Smith, built a rickety bridge of logs tied together with ropes and vines anchored on each bank. They also build a log raft to convey the artillery across the treacherous river. While hardly an engineering marvel, the bridge proved serviceable. Gen. M. Jeff Thompson, the “Swamp Fox,” assisted in building the rickety bridge.

[Picture: Gen. M. Jeff Thompson]

During the night on May 1, the Confederates began withdrawing across the St. Francis River, one brigade at a time, to the high ground at Chalk Bluff on the Arkansas side. The fragile bridge supported only a single file of troops. Horses had to swim the swirling river and several drowned in the process. Thompson, in charge of crossing the artillery, disassembled the guns and sent the parts over the river on a raft. By daylight on May 2, Marmaduke’s entire command, except pickets and a few stragglers, had cross the river, with the Federals totally unaware of the movement. The Confederates cast off the bridge and raft and let them drift away downstream.

Later that morning, McNeil’s brigades moved toward the river, hoping to destroy the Confederate command. The rebels on the Arkansas shore greeted them with heavy fire that unhorsed McNeil and his aide and killed and wounded several of his men. The Union artillery opened a heavy, but ineffective cannonade. The Confederates marched away without loss, thus concluding the fight at Chalk Bluff.

Aftermath of the Battle of Chalk Bluff

Casualties from the encounter at Chalk Bluff cannot be determined with certainty, but they were doubtless low. Vandever estimated Union losses at no more than 50 killed, wounded and missing. The Confederates probably suffered similar losses.

Marmaduke scored a tactical victory at Chalk Bluff by avoiding a major engagement with his back against the river, thereby saving his army. But strategically his raid had been a failure. He could not maintain a presence in Missouri and gained only enough recruits to replace his losses. His men remained poorly armed and fed. The raid did not divert the Federals from moving into northern Arkansas. Gen. U.S. Grant initiated his final campaign for Vicksburg on May 1 by defeating the Confederates at Port Gibson, Miss. This was the same day that Marmaduke fought a delaying action to avoid disaster on the St. Francis River.